



*Welcome*



**RUBY LANDS**

[www.greenfieldproperties.in](http://www.greenfieldproperties.in)

# ABOUT US

---

Greenfield Ruby lands at avinashi road project comprises DTCP approval plots spread across 50 acres of land. All our projects are Vasthu complaint.

The sprawling landscape and manicured gardens give a resort-like feeling.

The clubhouse boasts of all modern amenities. We care about the privacy and safety of our residents, thus we have 24 hours security guards service.

The project is curated amidst a relaxed ambiance with wide approach roads.

It is value for money and a good appreciation for investment purposes.

The villas boast of 3BHK projects.



# AMENITIES

---



- Community Hall
- Rain Water Harvesting
- Maintenance Staff
- Water Storage
- Private Garden
- Waste Disposal
- Terrace
- Security
- Vaastu
- Park
- Gym



Home is the starting  
place of love,  
hope and dreams.”

# Location Highlights

- 📍 Royal Care Hospital
- 📍 PSG Tech Park
- 📍 International Air-Port
- 📍 Kathir Engineering college
- 📍 Chaitanya CBSC School

Ruby Lands located in the most preferred area as well as closer to key landmarks in the city of Coimbatore with fresh and pollution-free environment which offers a life style. Every Greenfield home bears the hallmark of quality. We do not compromise on material and method of construction. We use premium fittings and fixtures while doing up the interiors.



Greenfield Housing India presents the new-age Villas with all modern amenities. The 50 acres project of GreenField Ruby Lands is located at Avanashi Road, Neelambur, Coimbatore. This project offers Individual Plots and 3/4 BHK Villas.



# Site Images

---

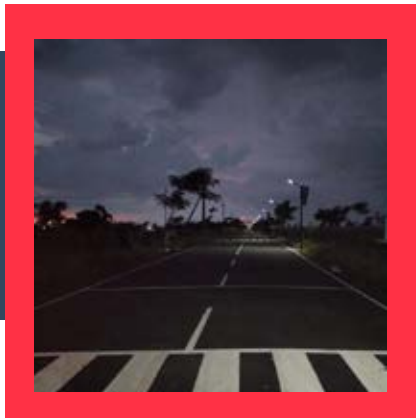
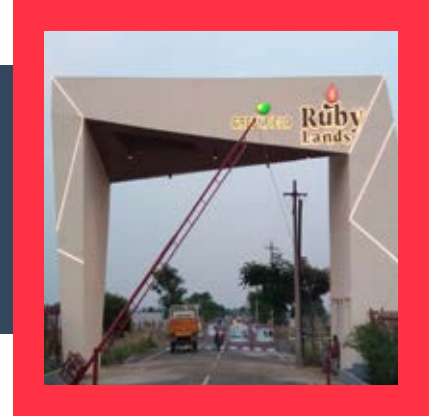

# Phase - 1 Layout



Plan Showing the Layout of House Sites in S.F.No: 438/2C, 439/1B & 440/1A  
At Vellanaipatti Village & Panchayat, Annur Taluk, Coimbatore District.

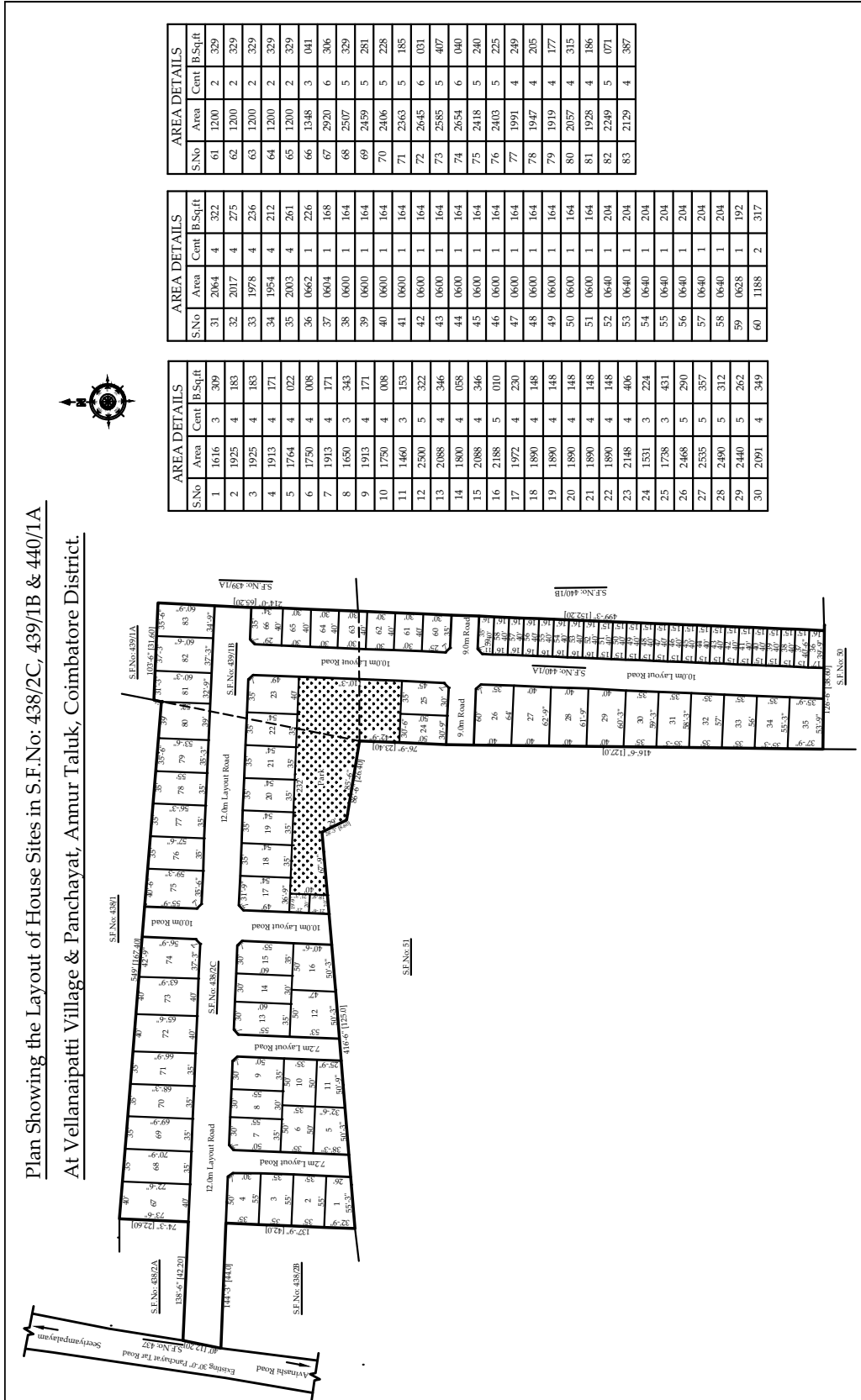

# Phase - 1 Approved Plan





# Phase - 1 RERA Approved



File No.TNRERA/2212/2022

**TAMIL NADU REAL ESTATE REGULATORY AUTHORITY  
REGISTRATION CERTIFICATE OF PROJECT  
FORM 'C'**

[See rule 6(1)]

This registration is granted under section 5 of The Real Estate (Regulation and Development) Act, 2016 to the following project under project registration number

**TN/11/Layout/3623/2022, dated:16.05.2022**

**PROJECT NAME : "GREEN FIELD RUBY LANDS PHASE -I"**  
**Location of Site: Latitude: 11°05'16.0"N Longitude: 77°05'12. 2"E**

**Project Details & Address:**

Registration of Layout with 83 Plots comprised in Survey Nos. 438/2C, 439/1B & 440/1A of Vellanaipatti Village & Panchayat, Annoor Taluk, Sarkarchamakulam Panchayat Union, Coimbatore District. The Member-Secretary / Deputy Director, Coimbatore Local Planning Authority, accorded technical sanction for the Layout No.09/2021 Planning Permission No.12/2021 in RC No. 4953/2020/LPA, dated 22.01.2021. The President of Vellanaipatti Panchayat, Sarkarchamakulam Panchayat Union, approved the Layout in Letter RC No.003, dated 11.02.2021.

**Applicant :**

**M/s. Greenfield Housing India Pvt. Ltd.,**  
No.48/2, Sangu Nagar, Surampatti,  
Erode, Erode District – 638 011.

2. This registration is granted subject to the following conditions, namely:-

- (i) The promoter shall enter into an agreement for sale with the allottees as provided in 'Annexure A' of Rule 9;
- (ii) The promoter shall deposit seventy percent of the amounts realized by the promoter in a separate account to be maintained in a schedule bank as per sub-clause (D) of clause (I) of sub-section (2) of section 4 of the Act;
- (iii) The promoter shall comply with the provisions of the Act and the rules and regulations made there under;
- (iv) The promoter shall not contravene the provisions of any other law for the time being in force in the area where the project is being developed.
- (v) This Registration is given based on the declaration given by you. The Registration of the Project does not amount to regularization of any violation of rules. If there is any violation/deviation to the approved plan, it is the responsibility of the Promoter to get it regularized from the competent Authority and inform this Authority.

3. If the above mentioned conditions are not fulfilled by the promoter, the regulatory authority may take necessary action against the promoter including revoking the registration granted herein, as per the Act and the rules and regulations made there under.

Dated:16.05.2022  
Place: Chennai-8

  
Signature and seal of the Authorized Officer  
Tamil Nadu Real Estate Regulatory Authority

ADVERTISMENT IN ANY FORM  
SHOULD CONTAIN RERA  
REGISTRATION NUMBER AND  
WEBSITE ADDRESS OF THIS  
AUTHORITY ([www.rera.tn.gov.in](http://www.rera.tn.gov.in))

Additional Director  
(Operation),  
TNRERA, Chennai-8.





# Phase - 2 Layout



Plan Showing Surrounding Details in S.F.No: 439/1A, 2, 3, 4, 440/1B, 2, 441/1, 2, 3 & 4 At Vellanaipatti Village & Panchayat, Annur Taluk, Coimbatore District.

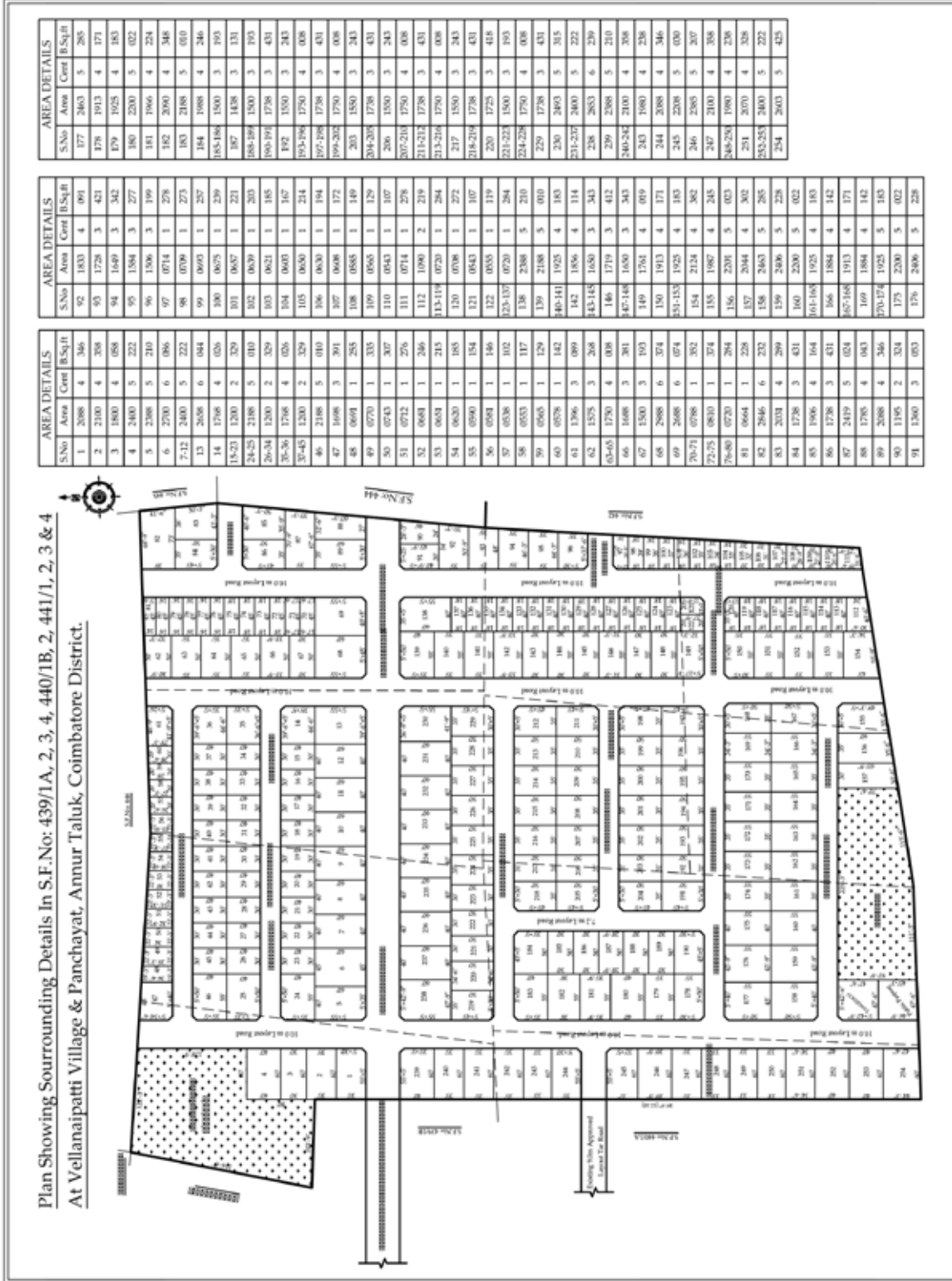











**Phase - II**

**Phase - I**

SR No : 446

SR No : 435

SR No : 438

SR No : 444

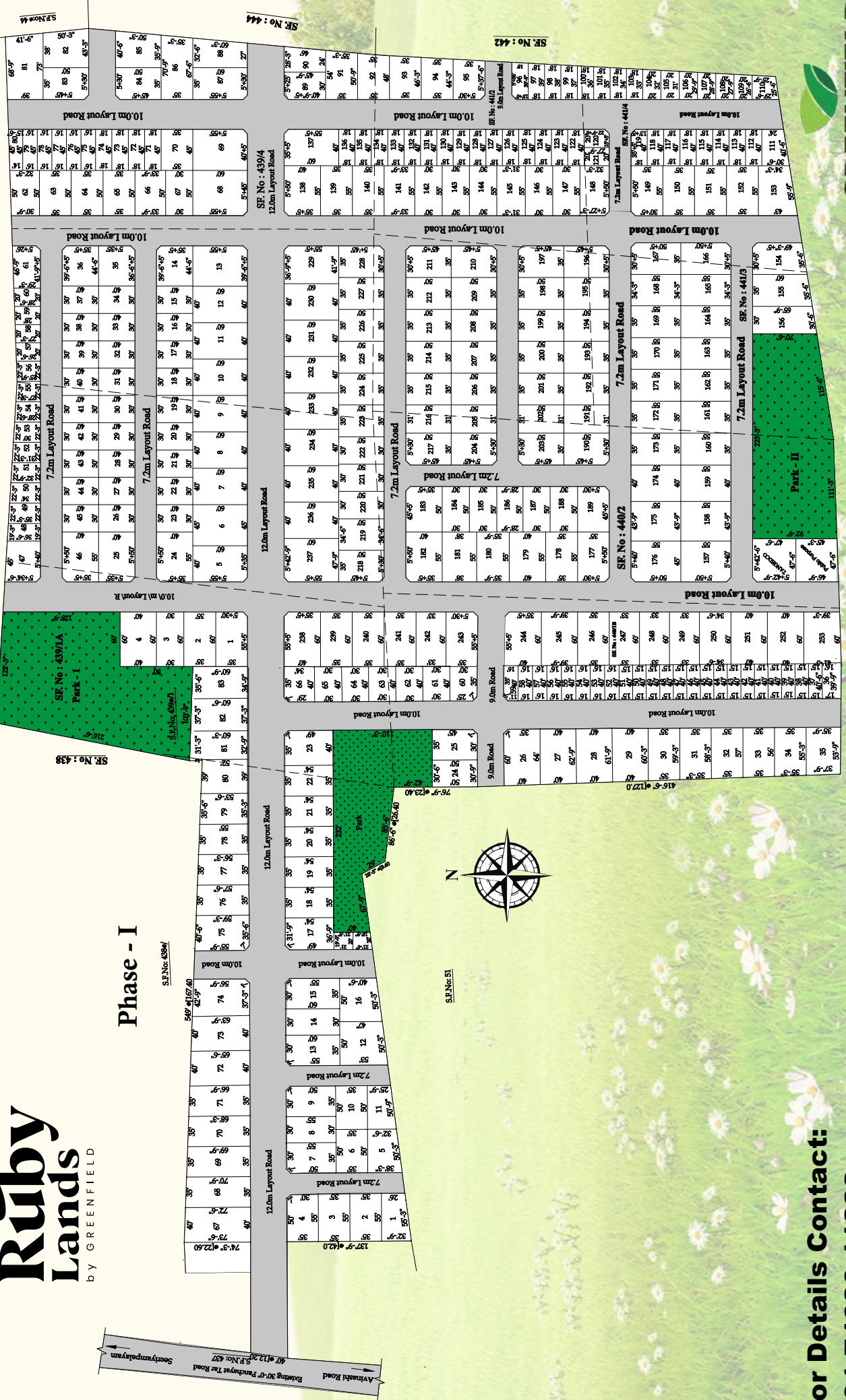

**For Details Contact:  
+91 74026 11222**

# Phase - I

A R E A D E T A I L S			
S.No	Area	Cent	B.Sq.ft
1	1 6 1 3	3 0 9	3 2 2
2	1 9 2 4	1 8 3	2 7 5
3	1 9 2 4	1 8 3	2 7 5
4	1 9 1 4	1 7 1	2 1 2
5	1 7 6 4	0 2 2	2 6 1
6	1 7 5 4	0 0 8	2 2 6
7	1 9 1 4	1 7 1	1 6 8
8	1 6 5 3	3 4 3	1 6 4
9	1 9 1 4	1 7 1	1 6 4
10	1 7 5 4	0 0 8	1 6 4
11	1 4 6 3	1 5 3	1 6 4
12	2 5 0 5	3 2 2	1 6 4
13	2 0 8 4	3 4 6	1 6 4
14	1 8 0 4	0 5 8	1 6 4
15	2 0 8 4	3 4 6	1 6 4
16	2 1 8 5	0 1 0	1 6 4
17	1 9 7 4	2 3 0	1 6 4
18	1 8 9 4	1 4 8	1 6 4
19	1 8 9 4	1 4 8	1 6 4
20	1 8 9 4	1 4 8	1 6 4
21	1 8 9 4	1 4 8	1 6 4
22	1 8 9 4	1 4 8	2 0 4
23	2 1 4 4	4 0 6	2 0 4
24	1 5 3 3	2 2 4	1 2 0 4
25	1 7 3 3	4 3 1	2 0 4
26	2 4 6 5	2 9 0	2 0 4
27	2 5 3 5	3 5 7	2 0 4
28	2 4 9 5	3 1 2	2 0 4
29	2 4 4 5	2 6 2	1 1 9 2
30	2 0 9 4	3 4 9	2 3 1 7

A R E A D E T A I L S			
S.No	Area	Cent	B.Sq.ft
6 1	1 2 0 2	3 2 9	3 2 9
6 2	1 2 0 2	3 2 9	3 2 9
6 3	1 2 0 2	3 2 9	3 2 9
6 4	1 2 0 2	3 2 9	3 2 9
6 5	1 2 0 2	3 2 9	3 2 9
6 6	1 3 4 3	0 4 1	0 4 1
6 7	2 9 2 6	3 0 6	3 0 6
6 8	2 5 0 5	3 2 9	3 2 9
6 9	2 4 5 5	2 8 1	2 8 1
7 0	2 4 0 5	2 2 8	2 2 8
7 1	2 3 6 5	1 8 5	1 8 5
7 2	2 6 4 6	0 3 1	0 3 1
7 3	2 5 8 5	4 0 7	4 0 7
7 4	2 6 5 6	0 4 0	0 4 0
7 5	2 4 1 5	2 4 0	2 4 0
7 6	2 4 0 5	2 2 5	2 2 5
7 7	1 9 9 4	2 4 9	2 4 9
7 8	1 9 4 4	2 0 5	2 0 5
7 9	1 9 1 4	1 7 7	1 7 7
8 0	2 0 5 4	3 1 5	3 1 5
8 1	1 9 2 4	1 8 6	1 8 6
8 2	2 2 4 5	0 7 1	0 7 1
8 3	2 1 2 4	3 8 7	3 8 7

A R E A D E T A I L S			
S.No	Area	Cent	B.Sq.ft
1	2088	4	346
2	2100	4	358
3	1800	4	058
4	2400	5	222
5	2388	5	210
6	2700	6	086
7-12	2400	5	222
13	2688	6	044
14	1768	4	026
15-23	1200	2	329
24-25	2188	5	010
26-34	1200	2	329
35-36	1768	4	026
37-45	1200	2	329
46	2188	5	010
47	1698	3	391
48	0691	1	255
49	0770	1	335
50	0743	1	307
51	0712	1	276
52	0681	1	246
53	0651	1	215
54	0620	1	185
55	0590	1	154
56	0581	1	146
57	0538	1	102
58	0553	1	117
59	0565	1	129
60	0578	1	142
61	1396	3	089
62	1575	3	268
63-65	1750	4	008
66	1688	3	381
67	1500	3	193
68	2988	6	374
69	2688	6	074
70	1575	3	268
71-74	0810	1	374
75-79	0720	1	284
80	0664	1	228
81	2846	6	232
82	2031	4	289
83	1738	3	431
84	1738	3	431
85	1906	4	164
86	2419	5	024
87	2088	4	346
88	1785	4	043
89	1360	3	053
90	1195	2	324

A R E A D E T A I L S			
S.No	Area	Cent	B.Sq.ft
91	1833	4	091
92	1728	3	421
93	1649	3	342
94	1584	3	277
95	1506	3	199
96	0714	1	278
97	0709	1	273
98	0693	1	257
99	0675	1	239
100	0657	1	221
101	0639	1	203
102	0621	1	185
103	0603	1	167
104	0650	1	214
105	0630	1	194
106	0608	1	172
107	0585	1	149
108	0565	1	129
109	0543	1	107
110	0714	1	278
111	1090	2	219
112-118	0720	1	284
119	0708	1	272
120	0543	1	107
121	0555	1	119
122-136	0720	1	284
137	2388	5	210
138	2188	5	010
139-140	1925	4	183
141	1856	4	114
142-144	1650	3	343
145	1719	3	412
146-147	1650	3	343
148	1761	4	019
149	1913	4	171
150-152	1925	4	183
153	2124	4	382
154	1987	4	245
155	2201	5	023
156	2044	4	302
157	2463	5	285
158	2406	5	228
159	2200	5	022
160-164	1925	4	183
165	1884	4	142
166-167	1913	4	171
168	1884	4	142
169-173	1925	5	183
174	2200	5	022
175	2406	5	228

A R E A D E T A I L S			
S.No	Area	Cent	B.Sq.ft
176	2463	5	285
177	1913	4	171
178	1925	4	183
179	2200	5	022
180	1966	4	224
181	2090	4	348
182	2188	5	010
183	1988	4	246
184-185	1500	3	193
186	1438	3	131
187-188	1500	3	193
189-190	1738	3	431
191	1550	3	243
192-195	1750	4	008
196-197	1738	3	431
198-201	1750	4	008
202	1550	3	243
203-204	1738	3	431
205	1550	3	243
206-209	1750	4	008
210-211	1738	3	431
212-215	1750	4	008
216	1550	3	243
217-218	1738	3	431
219	1725	3	418
220-222	1500	3	193
223-227	1750	4	008
228	1738	3	431
229	2493	5	315
230-236	2400	5	222
237	2853	6	239
238	2388	5	210
239-241	2100	4	358
242	1980	4	238
243	2088	4	346
244	2388	5	210
245	2385	5	207
246	2100	4	358
247-249	1980	4	238
250	2070	4	328
251-252	2400	5	222
253	2415	5	237

# Phase - II



- DTCP APPROVED PLOTS
- APARTMENTS
- DTCP APPROVED VILLAS
- FARM LAND

## Thank you for making us your first choice

We are the one of the top real estate Developers & Builders in Coimbatore, which offers Luxury villas, Residential apartments, DTCP & RERA approved sites and villas (under construction) at affordable price.. Explore our project in Coimbatore, which is our primary location.

Avinashi Road | Trichy Road & Sathy Road

### Our Ongoing Projects:



**Contact Us :** It's our pleasure serving you ! Don't hesitate to call us (24/7)

GREENFIELD C.KARTHIK - 📞 9944-674-860 | 9363-322-555

🌐 [www.greenfieldproperties.in](http://www.greenfieldproperties.in)